

CHARACTERISTICS

	STANDARD	AVAILABLE OPTIONS
Filtration	4 + 1 mm (two grids)	
Ports	DN 125 ISO PN16 Flanges	
Dimensions mm (in.)	D 146 (5.75)	
	E 150 (5.91)	
	F 182 (7.17)	
	G 158 (6.22)	
	L 329 (12.95)	
Weight kg (lbs)	35 (77.16)	

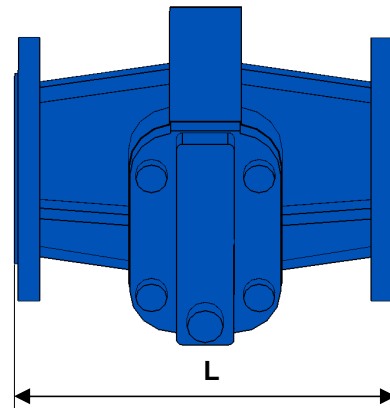
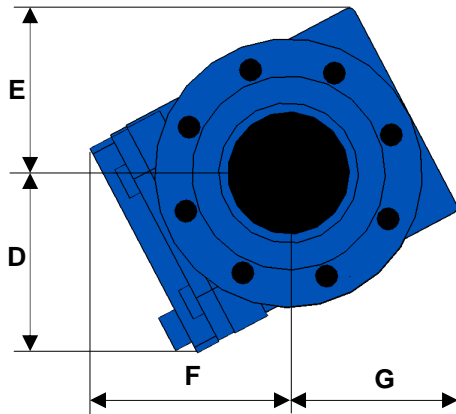

OPERATING LIMITS

	STANDARD MATERIALS	AVAILABLE OPTIONS
Minimum temperature °C (°F)	-10 (14)	
Maximum temperature °C (°F)	150 (302)	
Maximum working pressure bar (psi)	12 (174)	

MATERIALS OF CONSTRUCTION

Part No	PART NAME	STANDARD MATERIALS	AVAILABLE OPTIONS
2	Casing	Cast iron	
5	Cover	Cast iron	
6	4 mm grid (welded on cover)	Carbon steel	Stainless steel
6a	1 mm grid (removable)	Carbon steel	Stainless steel
	Screws	Carbon steel	
	Gaskets	Fibber Asbestos free	